



## Brondesbury Villas, NW6

- £2,350 Per Month

AVAILABLE TO LET FROM 3RD MARCH 2026- is this beautifully presented two bedroom First Floor apartment that has been tastefully refurbished, offering 657 sq ft of well laid out accommodation.

Offering high ceilings and hard wooden flooring throughout, the property offers a bright reception/dining room with a feature fireplace, a separate modern fitted fully equipped kitchen and two double bedrooms which are serviced by a three-piece family bathroom.

Located on a sought after road, just moments from local bars and restaurants of the area with good transport links including Queen's Park (Bakerloo Line & Lioness Line- Zone 2) and Kilburn High Street (Lioness- Zone 2). There are also local health clubs, gyms and outdoor activities within easy reach.

- 2 bedroom First Floor apartment
- Offering 657 sq ft of well laid out accommodation
- Period features & hard wooden flooring throughout
- Fully fitted modern kitchen
- Good transport links
- Deposit: £2,711
- COUNCIL: Brent (C)



020 7328 2828

[enquiries@cameronsstiff.co.uk](mailto:enquiries@cameronsstiff.co.uk)

[cameronsstiff.co.uk](http://cameronsstiff.co.uk)

## Brondesbury Villas, London, NW6

Approximate Area = 657 sq ft / 61 sq m

For identification only - Not to scale

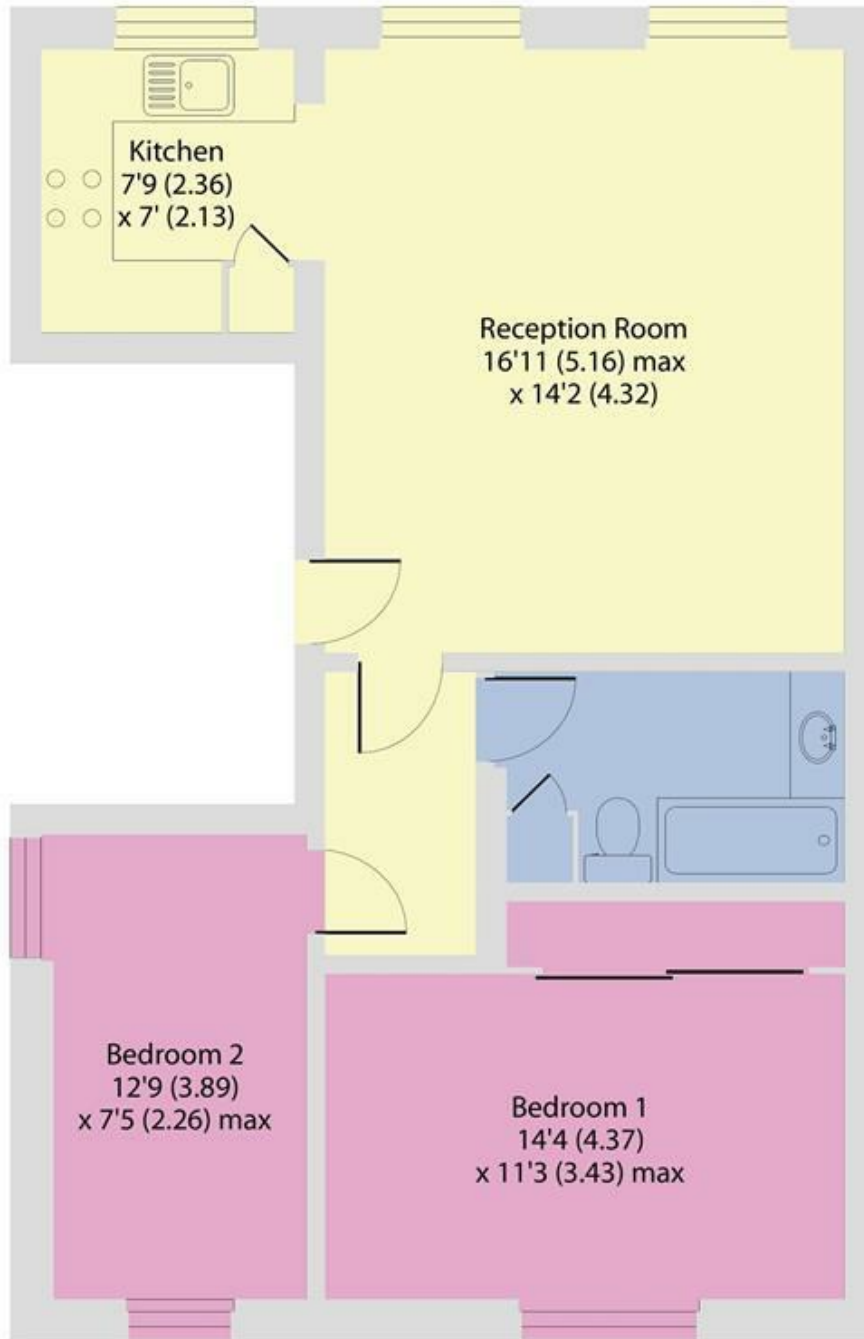

**FIRST FLOOR**

**EPC: C**  
Ref: 15083553



Floor plan produced in accordance with RICS Property Measurement 2nd Edition, Incorporating International Property Measurement Standards (IPMS2 Residential). © nichecom 2024. Produced for Camerons Stiff & Co. REF: 209197

